

REVISIONS		
ISS	ZONE	DESCRIPTION\PER REQUEST\DATE
B	A-1	NO.3 WAS CHANGED\RD-DM88072902C\07-29-99'
C	A-1	NO.1 WAS CHANGED\RD-DM89042001C\07-15-00'
D	B-1	NO.6 WAS CHANGED\RD-DM89103101Y\10-31-00'

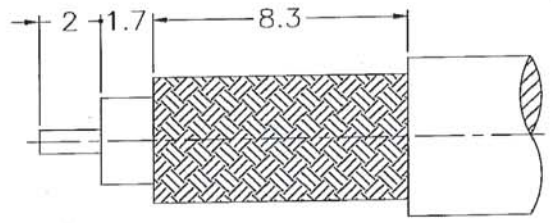

RECOMMENDED
CABLE STRIPPING DIM'S
(建議剝線尺寸)

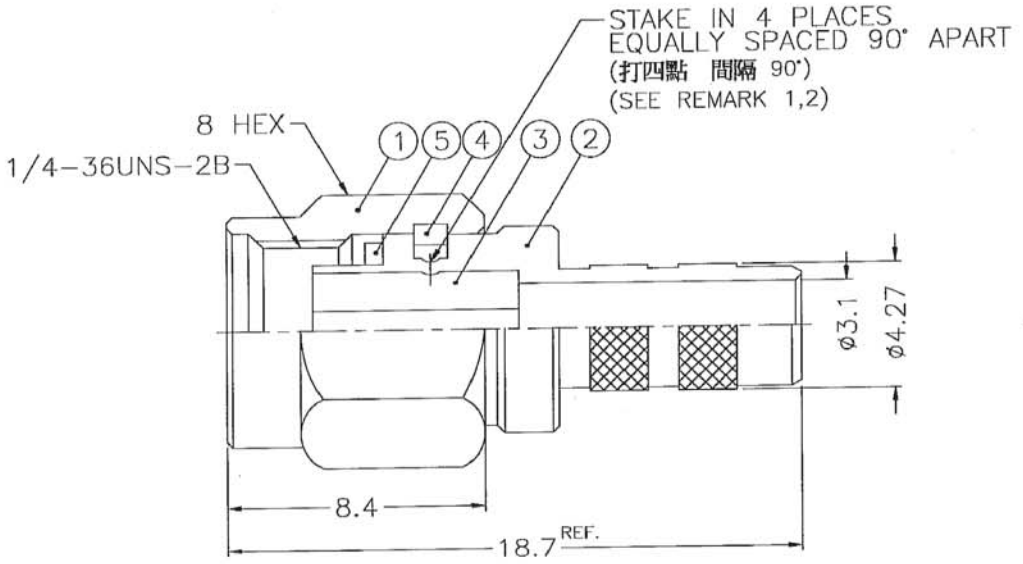
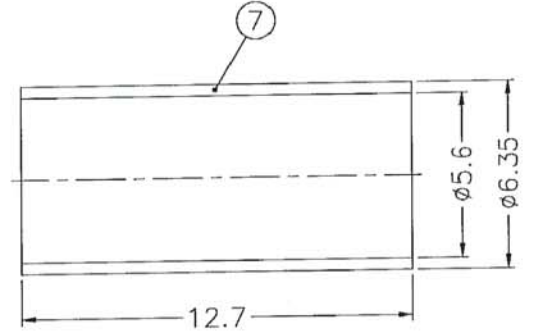
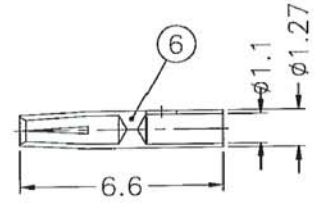

- NOTES: FINISH (PLATING THICKNESS IN MICRO-INCHES)
1. BRASS PER QQ-B-626
 2. GOLD PL. 3 MIN. THICK OVER NICKEL PL. 100 MIN. THICK OVER COPPER STRIKE
 3. BERYLLIUM COPPER PER QQ-C-530
 4. GOLD PL. 50 MIN. THICK OVER NICKEL PL. 100 MIN. THICK OVER COPPER STRIKE
 5. TEFLON MIL-P-19468
 6. JIS H 3250, C 2700

1. CRIMPED FERRULE
HEX CRIMP SIZE .213"
2. CONTACT PIN TO SOLDER

- REMARK:1. NO.3 MUST WITHSTAND A 6 lbs. MIN. PUSHOUT FORCE FROM NO.2 AFTER STAMPING OVER OPERATION
2. REMARK1 IS MAINTAINED BY STAMPING THE FOUR POINTS SHOWN ON THE DRAWING WITHOUT PUNCTURING NO.2
- (1.打四點后零件 3 由零件 2 推出至少必須承受 6 磅推力)
(2.打四點后除需符合備注 1 要求外 且不可擊穿零件 2)

NO.	DESCRIPTION	MATERIAL	FINISH	Q'TY	DRAWING NO.
7	FERRULE			1	FR-635/56X127
6	CONTACT PIN			1	SMA7081-3-127/11-B
5	GASKET	SILICONE	RED	1	GS-6/43X06
4	RETAINER RING		NATURAL	1	SMA5000-4-B
3	INSULATOR		NATURAL	1	RSMA1111A1-3T-50-B
2	BODY			1	RSMA1111A1-2-427/31
1	SHELL			1	SMA5000-1-C

DIMENSIONS ARE IN MILLIMETERS
UNLESS OTHERWISE SPECIFIED
TOLERANCES
0.5-6 = ±0.2
6-30 = ±0.4
30-120 = ±0.6
120-315 = ±1
315-1000 = ±1.6
1000-2000 = ±2.4

PART NO.		RSMA1111A1-3GT50-1A-50
APPROVED	DATE	11-06-00'
CHECKED	DATE	11-06-00'
DRAWN	DATE	11-06-00'

Amphenol-Kai Jack	
ShenZhen China	
TITLE SMA REVERSE POLARITY CRIMP PLUG	
DRAWING NO. RSMA1111A1-3GT50G-223U-50	
FILE NO. F:\DWG\RSMA\1111A1\223U-50\3GT50GSZ	

1928